

**NOTICE!!**

**These documents have been scanned!**

**Do not place un-scanned documents beneath this notice!**

**Do not remove this notice from this file!**

GPO Jacket No. 560-102  
Print Order 61540  
Rise Business Services, LLC  
Job=AZ15 5/10/2019



Box Number= AZ15035



Claim Begin-End: AMC426069-AMC426069

1 Initial Receipt



AZ15035-10

AMC425596-AMC426147

**United States Department of the Interior**  
**Bureau of Land Management**  
 LANDS/RECREATION & PLANNING  
 ONE N CENTRAL AVE  
 PHOENIX, AZ 85004 -2203  
 Phone: 602-417-9200

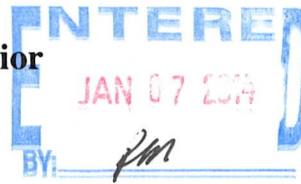

Receipt

No: 2939284

<b>Transaction #:</b> 3026898	
<b>Date of Transaction:</b> 12/30/2013	
<b>CUSTOMER:</b>	
NEV PROSPECT LLC 1490 STAR WAY RENO,NV 89511-8697 US	

LINE #	QTY	DESCRIPTION	REMARKS	UNIT PRICE	TOTAL
1	1.00	LOCATABLE MINERALS / MINING CLAIMS-NEW,UNADJUD, ONE OR MORE AUTH NOS / NEW MINING CLAIM LOCATION FEE \$34 <b>CASES:</b> AMC426069/\$34.00		- n/a -	34.00
2	1.00	LOCATABLE MINERALS / MINING CLAIMS-NEW,UNADJUD, ONE OR MORE AUTH NOS / NEW MINING CLAIM MAINT FEE \$140 <b>CASES:</b> AMC426069/\$140.00		- n/a -	140.00
3	1.00	LOCATABLE MINERALS / MINING CLAIMS-NEW,UNADJUD, ONE OR MORE AUTH NOS / NEW MINING CLAIM PROCESSING FEE <b>CASES:</b> AMC426069/\$20.00		- n/a -	20.00
<b>TOTAL:</b>					<b>\$194.00</b>

PAYMENT INFORMATION			
1	AMOUNT:	194.00	POSTMARKED: 12/23/2013
	TYPE:	CHECK	RECEIVED: 12/26/2013
	CHECK NO:	1404	
	NAME:	NEV PROSPECT LLC 1490 STAR WAY RENO NV 89511-8697 US	

REMARKS

This receipt was generated by the automated BLM Collections and Billing System and is a paper representation of a portion of the official electronic record contained therein.



**NOTICE!!**

**These documents have been scanned!**

**Do not place un-scanned documents beneath this notice!**

**Do not remove this notice from this file!**

GPO Jacket No. 560-102  
Print Order 61540  
Rise Business Services, LLC  
Job=AZ15 5/10/2019



Box Number= AZ15035



Claim Begin-End: AMC426069-AMC426069

2 Correspondence



AZ15035-10

AMC425596-AMC426147

**NO  
DOCUMENTS  
FOUND**

NO DOCUMENTS FOUND  
NO DOCUMENTS FOUND



**NOTICE!!**

**These documents have been scanned!**

**Do not place un-scanned documents beneath this notice!**

**Do not remove this notice from this file!**

GPO Jacket No. 560-102  
Print Order 61540  
Rise Business Services, LLC  
Job=AZ15 5/10/2019



Box Number= AZ15035



Claim Begin-End: AMC426069-AMC426069

3 Transfers

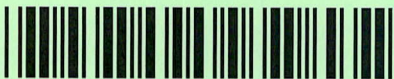

AZ15035-10

AMC425596-AMC426147

**NO  
DOCUMENTS  
FOUND**

NO DOCUMENTS FOUND  
NO DOCUMENTS FOUND



**NOTICE!!**

**These documents have been scanned!**

**Do not place un-scanned documents beneath this notice!**

**Do not remove this notice from this file!**

GPO Jacket No. 560-102  
Print Order 61540  
Rise Business Services, LLC  
Job=AZ15 5/10/2019



Box Number= AZ15035



Claim Begin-End: AMC426069-AMC426069

4 Miscellaneous



AZ15035-10

AMC425596-AMC426147

**NO  
DOCUMENTS  
FOUND**

NO DOCUMENTS FOUND  
NO DOCUMENTS FOUND



**NOTICE!!**

**These documents have been scanned!**

**Do not place un-scanned documents beneath this notice!**

**Do not remove this notice from this file!**

GPO Jacket No. 560-102  
Print Order 61540  
Rise Business Services, LLC  
Job=AZ15 5/10/2019



Box Number= AZ15035



Claim Begin-End: AMC426069-AMC426069

5 Annual Filings



AZ15035-10

AMC425596-AMC426147

426069

**MAINTENANCE FEE PAYMENT**

Claimant Name: Nev Prospect, LLC

Address: 1490 Star Way

City: Reno State: NY Zip: 89511

Telephone: 775-852-6909

E-mail address: \_\_\_\_\_

Signature: William A. Fuchs, Managing Member

Check here if this is a change of address.

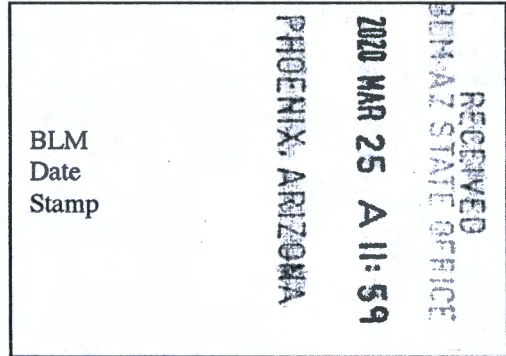

LINE NO.	AMC NUMBER	CLAIM/SITE NAME	COUNTY RECORDER DATA (If available)	TWP	RNG	SEC
1	426069	Felix 1	2013-06213	6S	27E	12
2						
3						
4						
5						
6						
7						
8						
9						
10						

List additional claims on Form MCF114.

No. of Claims\*: 1 x \$155 = \$165.00  
 Check No: 2484 Init. \$165  
 Receipt No.: \_\_\_\_\_  
 For BLM Use Only

**Bureau of Land Management  
Arizona State Office**  
[www.blm.gov/az/](http://www.blm.gov/az/)

\* \$155 per lode mining claim, mill site, or tunnel site; and \$155 for each 20 acres or portion thereof for each placer mining claim.

Form: MCF112  
Revised July 2014

**ENTERED**  
**APR 08 2020**  
 BY: RAM

This form is available from the **Arizona Geological Survey** and may be reproduced.

# 4719757



Nev Prospect, LLC  
1490 Star Way  
Reno, NV 89511



RECEIVED  
BLM AZ STATE OFFICE

2020 MAR 25 A 11:59

PHOENIX, ARIZONA

Bureau of Land Management  
Arizona State Office  
One North Central Ave., Ste. 800  
Phoenix, AZ 85004

8500434427

**United States Department of the Interior**  
**Bureau of Land Management**  
 DIV OF LANDS, MINRLS & ENERGY  
 ONE N CENTRAL AVE  
 PHOENIX, AZ 85004 -4427  
 Phone: 602-417-9200

Receipt	
No:	4719757

<b>Transaction #:</b> 4844987	
<b>Date of Transaction:</b> 03/27/2020	
<b>CUSTOMER:</b>	
NEV PROSPECT LLC 1490 STAR WAY RENO,NV 89511-8697 US	

LINE #	QTY	DESCRIPTION	REMARKS	UNIT PRICE	TOTAL
1	1.00	LOCATABLE MINERALS / MINING CLAIMS- NOT NEW-UNADJUD,ONE AUTH NO. ONLY / MINING CLAIM MONEY RECEIVED CASES: AMC426069/\$165.00		- n/a -	165.00
<b>TOTAL:</b>					<b>\$165.00</b>

PAYMENT INFORMATION			
1	<b>AMOUNT:</b>	165.00	<b>POSTMARKED:</b> N/A
	<b>TYPE:</b>	CHECK	<b>RECEIVED:</b> 03/27/2020
	<b>CHECK NO:</b>	2484	
	<b>NAME:</b>	NEV PROSPECT LLC 1490 STAR WAY RENO NV 89511-8697 US	

<b>REMARKS</b>

This receipt was generated by the automated BLM Collections and Billing System and is a paper representation of a portion of the official electronic record contained therein.



AMC 426069

**MAINTENANCE FEE PAYMENT**

Claimant Name: Nev Prospect, LLC  
Address: 1490 Star Way  
City: Reno State: NV Zip: 89511  
Telephone: 775-852-6909  
E-mail address: \_\_\_\_\_  
Signature: William A. Fuchs, Managing Member

Check here if this is a change of address.

RECEIVED  
BLM AZ STATE OFFICE  
2019 JUN 20 P 3:46  
PHOENIX, ARIZONA  
BLM  
Date  
Stamp

LINE NO.	AMC NUMBER	CLAIM/SITE NAME	COUNTY RECORDER DATA (If available)	TWP	RNG	SEC
1	426069	Felix 1	2013-06213	6 S	27 E	12
2						
3						
4						
5						
6						
7						
8						
9						
10						

List additional claims on Form MCF114.

**Bureau of Land Management**  
**Arizona State Office**  
www.blm.gov/az/

No. of Claims: 1 x ~~\$140~~<sup>155</sup> = \$155.00  
Check No: 2389 Init. \_\_\_\_\_  
Receipt No.: 4488297  
**For BLM Use Only**

Form: MCF112  
Revised July 2009

This form is available from the **Arizona Department of Mines and Mineral Resources** and may be reproduced.

ENTERED  
JUL 26 2019  
BY: [Signature]

**United States Department of the Interior**  
**Bureau of Land Management**  
 DIV OF LANDS, MINRLS & ENERGY  
 ONE N CENTRAL AVE  
 PHOENIX, AZ 85004 -4427  
 Phone: 602-417-9200

Receipt

No: 4488297 ✓

<b>Transaction #:</b> 4608409	
<b>Date of Transaction:</b> 06/21/2019	
CUSTOMER:	
NEV PROSPECT LLC 1490 STAR WAY RENO,NV 89511-8697 US	

LINE #	QTY	DESCRIPTION	REMARKS	UNIT PRICE	TOTAL
1	1.00	LOCATABLE MINERALS / MINING CLAIMS- NOT NEW-UNADJUD,ONE AUTH NO. ONLY / MINING CLAIM MONEY RECEIVED CASES: AMC426069/\$155.00	2020 MAINT (1)	- n/a -	155.00 ✓
<b>TOTAL:</b>					<b>\$155.00</b>

PAYMENT INFORMATION			
1	AMOUNT:	155.00	POSTMARKED: N/A
	TYPE:	CHECK	RECEIVED: 06/21/2019
	CHECK NO:	2389	
	NAME:	NEV PROSPECT LLC 1490 STAR WAY RENO NV 89511-8697 US	

REMARKS

This receipt was generated by the automated BLM Collections and Billing System and is a paper representation of a portion of the official electronic record contained therein.



Additional

**MAINTENANCE FEE PAYMENT**

Claimant Name: Nev Prospect, LLC  
 Address: 1490 Star Way  
 City: Reno State: NV Zip: 89511  
 Telephone: 775-852-6909  
 E-mail address: \_\_\_\_\_  
 Signature: William A. Fuchs, Managing Member

Check here if this is a change of address.

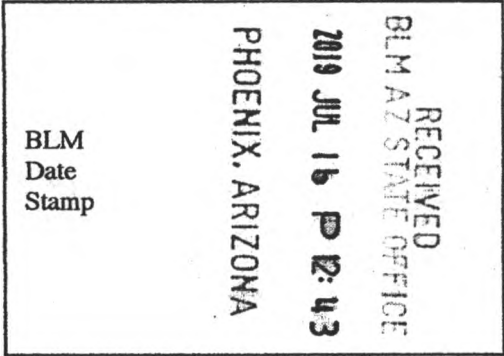

LINE NO.	AMC NUMBER	CLAIM/SITE NAME	COUNTY RECORDER DATA (If available)	TWP	RNG	SEC
1	426069	Felix 1	2013-06213	6S	27E	12
2						
3						
4						
5						
6						
7						
8						
9						
10						

List additional claims on Form MCF114.

**Bureau of Land Management**  
**Arizona State Office**  
 www.blm.gov/az/

No. of Claims: 1 x ~~\$140~~<sup>10</sup> = \$10.00  
 Check No: \_\_\_\_\_ Init. \_\_\_\_\_  
 Receipt No.: \_\_\_\_\_  
**For BLM Use Only**

Form: MCF112  
 Revised July 2009

This form is available from the Arizona Department of Mines and Mineral Resources and may be reproduced.

**ENTERED**  
 JUL 26 2019  
 BY: [Signature]

# 4510706

**United States Department of the Interior**  
**Bureau of Land Management**  
 DIV OF LANDS, MINRLS & ENERGY  
 ONE N CENTRAL AVE  
 PHOENIX, AZ 85004 -4427  
 Phone: 602-417-9200

Receipt	
No:	4510706

<b>Transaction #:</b> 4631221	
<b>Date of Transaction:</b> 07/18/2019	
<b>CUSTOMER:</b>	
NEV PROSPECT LLC 1490 STAR WAY RENO,NV 89511-8697 US	

LINE #	QTY	DESCRIPTION	REMARKS	UNIT PRICE	TOTAL
1	1.00	LOCATABLE MINERALS / MINING CLAIMS-NOT NEW-UNADJUD,ONE AUTH NO. ONLY / MINING CLAIM MONEY RECEIVED <b>CASES: AMC426069/\$10.00</b>	ADDITIONAL FEES	- n/a -	10.00
<b>TOTAL:</b>					<b>\$10.00</b>

PAYMENT INFORMATION			
1	AMOUNT:	10.00	POSTMARKED: N/A
	TYPE:	CHECK	RECEIVED: 07/16/2019
	CHECK NO:	2410	
	NAME:	NEV PROSPECT LLC 1490 STAR WAY RENO NV 89511-8697 US	

REMARKS

This receipt was generated by the automated BLM Collections and Billing System and is a paper representation of a portion of the official electronic record contained therein.



426069

**MAINTENANCE FEE PAYMENT**

Claimant Name: Neu Prospect, LLC

Address: 1490 Star Way

City: Reno State: NV Zip: 89511

Telephone: 775-852-6909

E-mail address: \_\_\_\_\_

Signature: William A. Fuchs, Managing Member

Check here if this is a change of address.

BLM  
Date  
Stamp

PHOENIX, ARIZONA

2018 MAR -8 P 1:51

RECEIVED

LINE NO.	AMC NUMBER	CLAIM/SITE NAME	COUNTY RECORDER DATA (If available)	TWP	RNG	SEC
1	426069	Felix 1	2013-06213	6S	27E	12
2						
3						
4						
5						
6						
7						
8						
9						
10						

List additional claims on Form MCF114.

**Bureau of Land Management**  
**Arizona State Office**  
www.blm.gov/az/

No. of Claims: 1 x  $\frac{\$140}{155} = \$155.00$

Check No: 2198 Init. \_\_\_\_\_

Receipt No.: 4108307

**For BLM Use Only**

This form is available from the **Arizona Department of Mines and Mineral Resources** and may be reproduced.

Form: MCF112  
Revised July 2009

**ENTERED**

**MAR 13 2018**

BY: RAM

Dev Prospect, LLC  
490 Star Way  
Reno, NV 89511

RENO NV 895

05 MAR 2018 PM 2 L

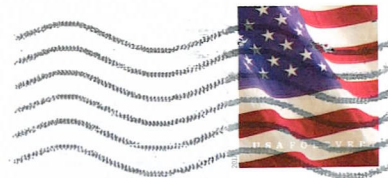

RECEIVED  
BLM ARIZONA STATE OFFICE  
2018 MAR -8 P 1:50  
PHOENIX, ARIZONA

Bureau of Land Management  
Arizona State Office  
One North Central Ave., Ste. 800  
Phoenix, AZ 85004-4427

8500434427





**United States Department of the Interior**  
**Bureau of Land Management**  
 DIV OF LANDS, MINRLS & ENERGY  
 ONE N CENTRAL AVE  
 PHOENIX, AZ 85004 -4427  
 Phone: 602-417-9200

Receipt

No: 4108307

<b>Transaction #:</b> 4221367	
<b>Date of Transaction:</b> 03/09/2018	
CUSTOMER:	
NEV PROSPECT LLC 1490 STAR WAY RENO,NV 89511-8697 US	

LINE #	QTY	DESCRIPTION	REMARKS	UNIT PRICE	TOTAL
1	1.00	LOCATABLE MINERALS / MINING CLAIMS- NOT NEW-UNADJUD,ONE AUTH NO. ONLY / MINING CLAIM MONEY RECEIVED <b>CASES: AMC426069/\$155.00</b>	MAINT 2018/1	- n/a -	155.00
<b>TOTAL:</b>					<b>\$155.00</b>

PAYMENT INFORMATION			
1	AMOUNT:	155.00	POSTMARKED: N/A
	TYPE:	CHECK	RECEIVED: 03/08/2018
	CHECK NO:	2198	
	NAME:	NEV PROSPECT LLC 1490 STAR WAY RENO NV 89511-8697 US	

REMARKS

This receipt was generated by the automated BLM Collections and Billing System and is a paper representation of a portion of the official electronic record contained therein.

426069

**MAINTENANCE FEE PAYMENT**

Claimant Name: Nev Prospect, LLC

Address: 1490 Star Way

City: Reno State: NV Zip: 89511

Telephone: 775-852-6909

E-mail address: \_\_\_\_\_

Signature: William A. Fauch, Managing Member

Check here if this is a change of address.

BLM  
Date  
Stamp

RECEIVED  
BLM ARIZONA OFFICE  
2017 FEB 21 P 2:50  
PHOENIX, ARIZONA

LINE NO.	AMC NUMBER	CLAIM/SITE NAME	COUNTY RECORDER DATA (If available)	TWP	RNG	SEC
1	426069	Felix 1	2013-06213	6S	27E	12
2						
3						
4						
5						
6						
7						
8						
9						
10						

List additional claims on Form MCF114.

**Bureau of Land Management**  
**Arizona State Office**  
www.blm.gov/az/

No. of Claims: 1 x ~~\$140~~<sup>155</sup> = \$155.00

Check No: 2062 Init. [Signature]

Receipt No.: 3268146

For BLM Use Only

Form: MCF112  
Revised July 2009

This form is available from the **Arizona Department of Mines and Mineral Resources** and may be reproduced.

ENTERED  
FEB 23 2017  
BY: [Signature]

Nev Prospect, LLC  
1490 Star Way  
Reno, NV 89511

RENO NV 895

15 FEB 2017 PM 3 L



RECEIVED  
BLM AZ

2017 FEB 21 P 2:39

PHOENIX, ARIZONA

Bureau of Land Management  
Arizona State Office  
One North Central Avenue, Ste. 800  
Phoenix, AZ 85004

8500434427





**United States Department of the Interior**  
**Bureau of Land Management**  
 DIV OF LANDS, MINRLS & ENERGY  
 ONE N CENTRAL AVE  
 PHOENIX, AZ 85004 -4427  
 Phone: 602-417-9200

Receipt

No: 3768146

<b>Transaction #:</b> 3874272	
<b>Date of Transaction:</b> 02/22/2017	
CUSTOMER:	
NEV PROSPECT LLC 1490 STAR WAY RENO,NV 89511-8697 US	

LINE #	QTY	DESCRIPTION	REMARKS	UNIT PRICE	TOTAL
1	1.00	LOCATABLE MINERALS / MINING CLAIMS- NOT NEW-UNADJUD,ONE AUTH NO. ONLY / MINING CLAIM MONEY RECEIVED <b>CASES: AMC426069/\$155.00</b>	MAINT FEE (1) 2018	- n/a -	155.00
<b>TOTAL:</b>					<b>\$155.00</b>

PAYMENT INFORMATION					
1	AMOUNT:	155.00	POSTMARKED:	02/15/2017	
	TYPE:	CHECK	RECEIVED:	02/21/2017	
	CHECK NO:	2062			
	NAME:	NEV PROSPECT, LLC 1490 STAR WAY RENO NV 89511-8697 US			

REMARKS

This receipt was generated by the automated BLM Collections and Billing System and is a paper representation of a portion of the official electronic record contained therein.

426069

**MAINTENANCE FEE PAYMENT**

Claimant Name: New Prospect, LLC

Address: 1490 Star Way

City: Reno State: NV Zip: 89511

Telephone: 775-852-6909

E-mail address: \_\_\_\_\_

Signature: William A. Fuchs, Managing Member

BLM Date Stamp	RECEIVED BLM & BUREAU OF LAND MANAGEMENT OFFICE
	2016 FEB - 8 P 3: 11

Check here if this is a change of address.

LINE NO.	AMC NUMBER	CLAIM/SITE NAME	COUNTY RECORDER DATA (If available)	TWP	RNG	SEC
1	426069	Felix 1	2013-06213	6S	27E	12
2						
3						
4						
5						
6						
7						
8						
9						
10						

List additional claims on Form MCF114.

Bureau of Land Management  
Arizona State Office  
www.blm.gov/az/

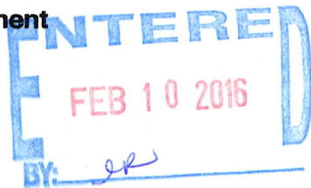

No. of Claims: <u>1</u> x <del>\$140</del> <sup>155</sup> = <u>\$155</u>
Check No: <u>1903</u> Init. <u>[Signature]</u>
Receipt No.: <u>348963</u>
<b>For BLM Use Only</b>

Form: MCF112  
Revised July 2009

Nev Prospect, LLC  
1490 Star Way  
Reno, NV 89511

RENO NV 895

02 FEB 2016 PM 2 T



RECEIVED  
2016 FEB -8 P 2:51

PHOENIX ARIZONA

Bureau of Land Management  
Arizona State Office  
One North Central Ave., Ste. 800  
Phoenix, AZ 85004-4427

850044427





**United States Department of the Interior**  
**Bureau of Land Management**  
 LANDS/RECREATION & PLANNING  
 ONE N CENTRAL AVE  
 PHOENIX, AZ 85004 -2203  
 Phone: 602-417-9200

Receipt

No: 3489603

<b>Transaction #:</b> 3589897	
<b>Date of Transaction:</b> 02/09/2016	
CUSTOMER:	
NEV PROSPECT LLC 1490 STAR WAY RENO,NV 89511-8697 US	

LINE #	QTY	DESCRIPTION	REMARKS	UNIT PRICE	TOTAL
1	1.00	LOCATABLE MINERALS / MINING CLAIMS- NOT NEW-UNADJUD,ONE AUTH NO. ONLY / MINING CLAIM MONEY RECEIVED CASES: AMC426069/\$155.00	MAINT 2016/1 <i>2017</i>	- n/a -	155.00
<b>TOTAL:</b>					<b>\$155.00</b>

PAYMENT INFORMATION			
1	AMOUNT:	155.00	POSTMARKED: 02/02/2016
	TYPE:	CHECK	RECEIVED: 02/08/2016
	CHECK NO:	1903	
	NAME:	NEV PROSPECT LLC 1490 STAR WAY RENO NV 89511-8697 US	

REMARKS

This receipt was generated by the automated BLM Collections and Billing System and is a paper representation of a portion of the official electronic record contained therein.

**MAINTENANCE FEE PAYMENT**

Claimant Name: Nev Prospect, LLC

Address: 1490 Star Way

City: Reno State: NV Zip: 89511

Telephone: 775-852-6909

E-mail address: \_\_\_\_\_

Signature: William A. Fuchs, Managing Member

Check here if this is a change of address.

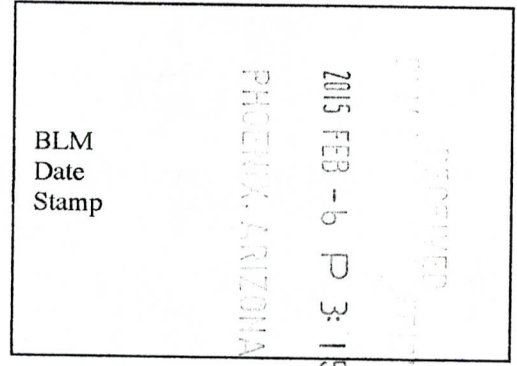

LINE NO.	AMC NUMBER	CLAIM/SITE NAME	COUNTY RECORDER DATA (If available)	TWP	RNG	SEC
1	426069	Felix 1	2013-06213	6S	27E	12
2						
3						
4						
5						
6						
7						
8						
9						
10						

List additional claims on Form MCF114.

**Bureau of Land Management**  
**Arizona State Office**  
[www.blm.gov/az/](http://www.blm.gov/az/)

No. of Claims: 1 x \$140 = #155  
 Check No: 1687 Init. W.A.F.  
 Receipt No.: 3224841  
**For BLM Use Only**

**Form: MCF112**  
Revised July 2009

William A. Fuchs  
1490 Star Way  
Reno, NV 89511

RENO NV 895

OFFICE OF THE POSTMASTER GENERAL



MI

RECEIVED  
BLM / POST OFFICE

2015 FEB -6 P 3:02

2015 FEB -6 P 3:02

PHOENIX, ARIZONA

PHOENIX, ARIZONA

Bureau of Land Management  
Lands/Recreation & Planning  
One N. Central Ave., Ste. 800  
Phoenix, AZ 85004

8500434427

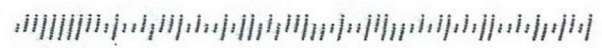



**United States Department of the Interior**  
**Bureau of Land Management**  
 LANDS/RECREATION & PLANNING  
 ONE N CENTRAL AVE  
 PHOENIX, AZ 85004 -2203  
 Phone: 602-417-9200

Receipt

No: 3224841

<b>Transaction #:</b> 3318708	
<b>Date of Transaction:</b> 02/09/2015	
CUSTOMER:	
NEV PROSPECT LLC 1490 STAR WAY RENO,NV 89511-8697 US	

LINE #	QTY	DESCRIPTION	REMARKS	UNIT PRICE	TOTAL
1	1.00	LOCATABLE MINERALS / MINING CLAIMS- NOT NEW-UNADJUD,ONE AUTH NO. ONLY / MINING CLAIM MONEY RECEIVED <b>CASES: AMC426069/\$155.00</b>	MAINT FEE PYMNT (1)	- n/a -	155.00
<b>TOTAL:</b>					<b>\$155.00</b>

PAYMENT INFORMATION					
1	AMOUNT:	155.00	POSTMARKED:	02/02/2015	
	TYPE:	CHECK	RECEIVED:	02/06/2015	
	CHECK NO:	1687			
	NAME:	NEV PROSPECT LLC 1490 STAR WAY RENO NV 89511-8697 US			

REMARKS

This receipt was generated by the automated BLM Collections and Billing System and is a paper representation of a portion of the official electronic record contained therein.

ENTERED  
 FEB 26 2015  
 BY: *Rpm*

AMC 426069

Additional  
**MAINTENANCE FEE PAYMENT** (\$140 already paid)

Claimant Name: Neu Prospect, LLC

Address: 1490 Star Way

City: Reno State: NV Zip: 89511

Telephone: 775-852-6909

E-mail address: \_\_\_\_\_

Signature: William A. Fuchs, Managing Member

Check here if this is a change of address.

RECEIVED  
BLM / STATE OFFICE  
2014 JUL - 8 P 2:59  
PHOENIX, ARIZONA

BLM  
Date  
Stamp

LINE NO.	AMC NUMBER	CLAIM/SITE NAME	COUNTY RECORDER DATA (If available)	TWP	RNG	SEC
1	426069	Felix 1	2013-06213	6S	27E	12
2						
3						
4						
5						
6						
7						
8						
9						
10						

List additional claims on Form MCF114.

**Bureau of Land Management**  
**Arizona State Office**  
www.blm.gov/az/

No. of Claims: 1 x \$~~140~~<sup>15</sup> = \$15.00  
 Check No: 1552 Init. AF  
 Receipt No.: 3073234  
 For BLM Use Only

Form: MCF112  
Revised July 2009

This form is available from the **Arizona Department of Mines and Mineral Resources** and may be reproduced.

**INTERE**  
**JUL 10 2014**  
 BY: RAM

W.A. Fuchs  
1490 Star Way  
Reno, NV 89511

RENO NV 895

05 JUL 2014 PM 2 L



RECEIVED

ARIZONA STATE OFFICE

2014 JUL -8 P 2: 56

PHOENIX, ARIZONA

Bureau of Land Management  
Arizona State Office  
One North Central Ave., Ste. 800  
Phoenix, AZ 85004-4427

Attn: Mining Claims

850044427





**United States Department of the Interior**  
**Bureau of Land Management**  
 LANDS/RECREATION & PLANNING  
 ONE N CENTRAL AVE  
 PHOENIX, AZ 85004 -2203  
 Phone: 602-417-9200

Receipt

No: 3073234

<b>Transaction #:</b> 3164364	
<b>Date of Transaction:</b> 07/09/2014	
CUSTOMER:	
NEV PROSPECT LLC 1490 STAR WAY RENO,NV 89511-8697 US	

LINE #	QTY	DESCRIPTION	REMARKS	UNIT PRICE	TOTAL
1	1.00	LOCATABLE MINERALS / MINING CLAIMS-NOT NEW-UNADJUD,ONE AUTH NO. ONLY / MINING CLAIM MONEY RECEIVED CASES: AMC426069/\$15.00	ADDL MAINT FEE PYMNT (1) 2015	- n/a -	15.00
<b>TOTAL:</b>					<b>\$15.00</b>

PAYMENT INFORMATION					
1	AMOUNT:	15.00	POSTMARKED:	07/05/2014	
	TYPE:	CHECK	RECEIVED:	07/08/2014	
	CHECK NO:	1552			
	NAME:	NEV PROSPECT LLC 1490 STAR WAY RENO NV 89511-8697 US			

REMARKS

This receipt was generated by the automated BLM Collections and Billing System and is a paper representation of a portion of the official electronic record contained therein.

AMC 426069

**MAINTENANCE FEE PAYMENT**

Claimant Name: Nev Prospect, LLC

Address: 1490 Star Way

City: Reno State: NV Zip: 89511

Telephone: 775-852-6909

E-mail address: \_\_\_\_\_

Signature: William A. Fuchs, Managing Member

Check here if this is a change of address.

RECEIVED BLM AZ STATE OFFICE	2014 JAN 31 PM 3:00	PHOENIX, ARIZONA	BLM Date Stamp
---------------------------------	---------------------	------------------	----------------------

LINE NO.	AMC NUMBER	CLAIM/SITE NAME	COUNTY RECORDER DATA (If available)	TWP	RNG	SEC
1	426069	Felix 1	2013-06213	6S	27E	12
2						
3						
4						
5						
6						
7						
8						
9						
10						

List additional claims on Form MCF114.

**Bureau of Land Management**  
**Arizona State Office**  
www.blm.gov/az/

No. of Claims: <u>1</u> x \$140 = <u>\$140.00</u> Check No: <u>1442</u> Init. <u>Asst.</u> Receipt No.: <u>2962558</u> <b>For BLM Use Only</b>
---

Form: MCF112  
Revised July 2009

This form is available from the **Arizona Department of Mines and Mineral Resources** and may be reproduced.

**ENTERED**

FEB 26 2014

BY: JM

William A. Fuchs  
1490 Star Way  
Reno, NV 89511

RENO NV 895

28 JAN 2014 PM 2 T

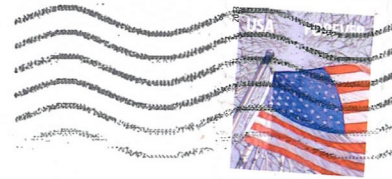

RECEIVED  
BLM AZ STATE OFFICE

2014 JAN 31 PM 2:50

PHOENIX, ARIZONA

Bureau of Land Management  
Arizona State Office  
One North Central Avenue, Ste. 800  
Phoenix, AZ 85004-4427

85004\$4427

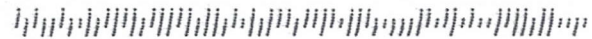



**United States Department of the Interior**  
**Bureau of Land Management**  
 LANDS/RECREATION & PLANNING  
 ONE N CENTRAL AVE  
 PHOENIX, AZ 85004 -2203  
 Phone: 602-417-9200

Receipt

No: 2962558

<b>Transaction #:</b> 3050611	
<b>Date of Transaction:</b> 02/04/2014	
CUSTOMER:	
NEV PROSPECT LLC 1490 STAR WAY RENO,NV 89511-8697 US	

LINE #	QTY	DESCRIPTION	REMARKS	UNIT PRICE	TOTAL
1	1.00	LOCATABLE MINERALS / MINING CLAIMS- NOT NEW-UNADJUD,ONE AUTH NO. ONLY / MINING CLAIM MONEY RECEIVED CASES: AMC426069/\$140.00	MAINT FEE PYMNT (1) 2015	- n/a -	140.00
<b>TOTAL:</b>					<b>\$140.00</b>

PAYMENT INFORMATION					
1	AMOUNT:	140.00	POSTMARKED:	01/28/2014	
	TYPE:	CHECK	RECEIVED:	01/31/2014	
	CHECK NO:	1442			
	NAME:	NEV PROSPECT LLC 1490 STAR WAY RENO NV 89511-8697 US			

REMARKS

This receipt was generated by the automated BLM Collections and Billing System and is a paper representation of a portion of the official electronic record contained therein.

**NOTICE!!**

**These documents have been scanned!**

**Do not place un-scanned documents beneath this notice!**

**Do not remove this notice from this file!**

GPO Jacket No. 560-102  
Print Order 61540  
Rise Business Services, LLC  
Job=AZ15 5/10/2019



Box Number= AZ15035



Claim Begin-End: AMC426069-AMC426069

6 Location Notices-Amendments and Supporting Documents



AZ15035-10

AMC425596-AMC426147



**DEPARTMENT OF THE INTERIOR  
BUREAU OF LAND MANAGEMENT  
MINING CLAIMS**

**(LIVE) Serial Register Page**

Run Date/Time: 01/07/2014 04:27 PM

Page 1 of 1

01 05-10-1872;017STAT0091;30USC26,28,34

**Total Acres**

**Serial Number**

Case Type 384101: LODE CLAIM

20.660

AMC426069

Claim Name: FELIX 1

**Lead File Number**

Commodity :

AMC426069

Case Disposition: ACTIVE

Required Maintenance Fee: \$140.00

Name & Address	Int Rel
NEV PROSPECT LLC 1490 STAR WAY RENO, NV 89511-8697	CLAIMANT

Mer Twp	Rng	Sec	Quadrant	District/Field Office	County
14	0060S	0270E	012 SE	SAFFORD FO	GRAHAM

Act Date	Code	Action	Action Remarks	Receipt Number
12/14/2013	403	LOCATION DATE		
12/26/2013	395	RECORDATION NOTICE RECD	1	2939284
12/26/2013	484	LOCATION YEAR / MAINTENANC	2014;\$140	2939284
12/26/2013	501	ACCT ADV IN LEAD FILE	AMC426069;	

Line Nr Remarks

---



**MINING CLAIM STATUS REPORT**

Data Entered: 1/7/2014 PM

MTP Checked By: [Signature]

GEO Checked By: [Signature]

LEAD SERIAL NUMBER: AMC 426069 thru AMC \_\_\_\_\_

**NUMBER OF CLAIMS & TYPE:**

1 LODE  
\_\_\_\_ PLACER  
\_\_\_\_ ASSOCIATION PLACER  
\_\_\_\_ MILL SITE  
\_\_\_\_ TUNNEL SITE

**CHARGES:**

Location Fee @ \$34 = \$ 34  
Processing Fee @ \$20 = \$ 20  
Maintenance Fee @ \$140 = \$ 140  
Add'l Maint Fee for Assoc Placer = \$ \_\_\_\_\_

**SUBTOTAL** \$ \_\_\_\_\_

TOTAL ACREAGE: \_\_\_\_\_ Per Claim  
(Placer Only)

Other Fees \$ \_\_\_\_\_

Other Fees \$ \_\_\_\_\_

NUMBER OF LOCATORS: \_\_\_\_\_

**TOTAL** \$ 194

DOCUMENTS RECEIVED VIA : Over-the-Counter [ ] Mail [  ] **TIMELY FILED:** Yes [  ] No [ ]

LEGAL DESCRIPTION: T 65 R 27E SEC 12  
T \_\_\_\_\_ R \_\_\_\_\_ SEC \_\_\_\_\_  
T \_\_\_\_\_ R \_\_\_\_\_ SEC \_\_\_\_\_  
T \_\_\_\_\_ R \_\_\_\_\_ SEC \_\_\_\_\_  
T \_\_\_\_\_ R \_\_\_\_\_ SEC \_\_\_\_\_

BLM [ ] FOREST SERVICE [ ] \_\_\_\_\_ SUBJ TO PL 359: Yes [ ] No [ ]  
WILDERNESS AREA [ ] \_\_\_\_\_

SPLIT ESTATE: N/A [ ] SX [ ] PX [ ] OTHER [ ] \_\_\_\_\_  
SRHA [ ] Was proper Notice filed if located on SHRA Land? Yes [ ] No [ ]

**RECONVEYED MINERALS ON BLM LAND REQUIRE OPENING ORDER FROM 1944 TO 1993:**

Open to Entry On \_\_\_\_\_ N/A [ ]

COMMENTS/STATUS: VOID [ ] PARTIALLY VOID [ ] PVT MINERALS [ ] WITHDRAWN LANDS [ ]  
OTHER [ ] \_\_\_\_\_

[ ] Claimant acknowledges that portions of the following claim(s) site(s) may be void or voidable.

Printed Name of Claimant \_\_\_\_\_ Signature of Claimant \_\_\_\_\_

\*\*\*\*\*FINAL ADJUDICATION\*\*\*\*\*

DATE 6/2/14 INITIALS AT

14NC426069

**Certificate of Location**

This is to certify that the **Felix 1** lode mining claim was located by

Nev Prospect, LLC  
of  
1490 Star Way  
Reno, Nevada 89511

on the 14<sup>th</sup> day of December 2013, situated in or near the Lone Star Mining District of Graham County, State of Arizona.

Said claim is located in the SE ¼ of Section 12, T 6 S, R 27 E, Gila and Salt River Base and Meridian. The claim is 600 feet wide and 1500 feet long. The general course of the claim is from north to south and the locators claim 100 feet in a north direction and 1400 feet in a south direction from the location monument (a 2"x2"x4' wood post), together with 300 feet on each side of the center of the lode. The location notice is posted at the location monument (UTM NAD 1927 zone 12S coordinates 636977 E, 3643568 N).

The detailed location of each corner is shown on the required map filed with this location certificate. Each of the four corners and end centers is marked with a 2"x2"x4' wooden post, inscribed with the name of the claim and appropriate designation of the corner on metal tags. The description of such claim is: beginning at the Northeast Corner,  
thence, south 1500 feet to the SE Corner  
thence, west 600 feet to the SW Corner  
thence, north 1500 feet to the NW Corner  
thence, east 600 feet to the NE Corner

the point and place of beginning. The northwest corner of section 12 (a surveyed brass cap) has UTM coordinates of 636063E, 3644511N, Zone 12S, and the northwest corner of the Felix 1 claim lies 913 meters (2995 feet) south and 823 meters (2700 feet) east of said northwest corner of section 12 ("south" and "east" are oriented on the UTM grid).

The monumenting and marking of the corners was completed by the 14<sup>th</sup> day of December 2013.

Two copies of the claim map have been filed with the Graham County Recorder and the lode claim filing fee has been paid to the County Recorder.

Locators:

William A. Fuchs      12/14/13  
William A. Fuchs      Date

Victoria S. Fuchs      12/14/13  
Victoria S. Fuchs      Date

AMC 426069

RECEIVED  
BLM AZ STATE OFFICE

2013 DEC 26 PM 3:09

PHOENIX ARIZONA

3024898



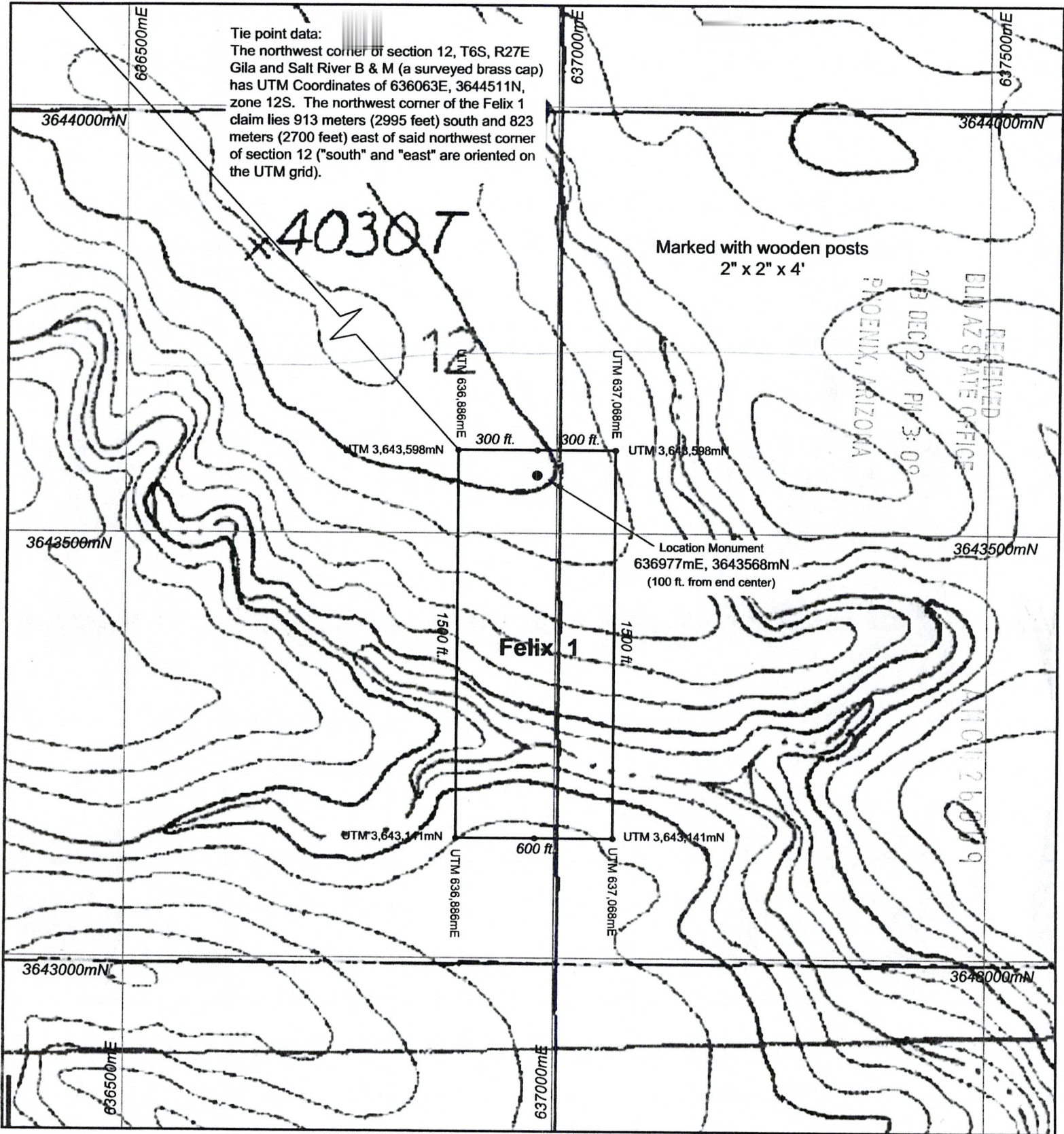

Located By:  
 Nev Prospect, LLC  
 1490 Star Way  
 Reno, Nevada 89511

Lone Star Mountain  
 7.5' USGS Topo Quad  
 UTM NAD 1927 Zone 12S

**Claim Map of the Felix 1  
 Lode Mining Claim**  
 T6S, R27E Section 12 SE1/4  
 Gila and Salt River B&M  
 Graham County, Arizona

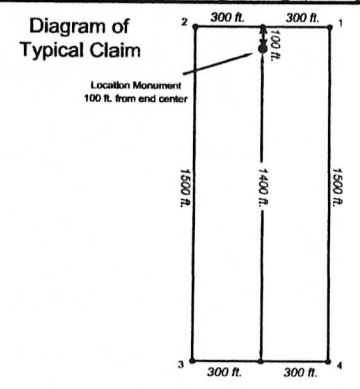
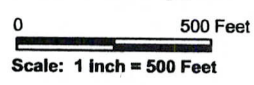



Input Parameters for Geographic Report with Land

System Id = CR

Admin State = AZ

Geo State =

Casetype Begins With

Case Disp Txt = AUTHORIZED, CANCELLED, EXPIRED, PENDING, REJECTED, RELINQUISHED, VOID, WITHDRAWN

Mer Twp Rng = 14 0060S 0270E

Section = 012, 999

Mtrs =

Commodity =

Commodity Txt =

Pending Org =

Pend Org Decode =

Total Rows Returned: 0



William A. Fuchs  
1490 Star Way  
Reno, NV 89511

RENO NV 894



USA  
Justice  
FOREVER

23 DEC 2013 PM 3 1

RECEIVED  
BLM AZ STATE OFFICE

2013 DEC 26 PM 2:36

PHOENIX, ARIZONA

Bureau of Land Management  
Arizona State Office  
One North Central Ave., Ste. 800  
Phoenix, AZ 85004-4427

85004+4427

